

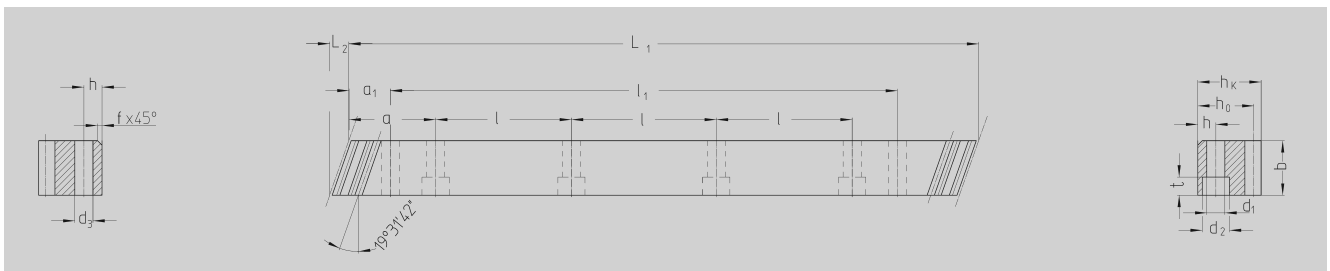

**Quality 10**



Order Code	Module	L <sub>1</sub>	L <sub>2</sub>	N° of Teeth	b	h <sub>k</sub>	h <sub>0</sub>	f	a	l	N° of Holes	h	d <sub>1</sub>	d <sub>2</sub>	t	a <sub>1</sub>	l <sub>1</sub>	d <sub>3</sub>	kg	
39 15 050 <sup>2)</sup>	1.5	500.00	6.02	100	17	17	15.5	2	62.5	125	4	6	6	10	6	31.7	436.6	5.7	1.30	
39 16 050	1.5	500.00	6.02	100	17	17	15.5	2				without Mounting Holes								1.30
39 15 100	1.5	1000.00	6.02	200	17	17	15.5	2	62.5	125	8	6	6	10	6	31.7	936.6	5.7	2.60	
39 16 100	1.5	1000.00	6.02	200	17	17	15.5	2				without Mounting Holes								2.60
39 20 050 <sup>2)</sup>	2	500.00	8.87	75	25	24	22	2	62.5	125	4	8	7	11	7	31.7	436.6	5.7	2.10	
39 21 050	2	500.00	8.87	75	25	24	22	2				without Mounting Holes								2.10
39 20 100	2	1000.00	8.87	150	25	24	22	2	62.5	125	8	8	7	11	7	31.7	936.6	5.7	4.20	
39 21 100	2	1000.00	8.87	150	25	24	22	2				without Mounting Holes								4.20
39 20 200	2	2000.00	8.87	300	25	24	22	2	62.5	125	16	8	7	11	7	31.7	1936.6	5.7	8.40	
39 21 200	2	2000.00	8.87	300	25	24	22	2				without Mounting Holes								8.40
39 30 050 <sup>2)</sup>	3	500.00	10.64	50	30	29	26	2	62.5	125	4	9	10	15	9	35.0	430.0	7.7	3.00	
39 31 050	3	500.00	10.64	50	30	29	26	2				without Mounting Holes								3.00
39 30 100	3	1000.00	10.64	100	30	29	26	2	62.5	125	8	9	10	15	9	35.0	930.0	7.7	6.00	
39 31 100	3	1000.00	10.64	100	30	29	26	2				without Mounting Holes								6.00
39 30 200	3	2000.00	10.64	200	30	29	26	2	62.5	125	16	9	10	15	9	35.0	1930.0	7.7	12.00	
39 31 200	3	2000.00	10.64	200	30	29	26	2				without Mounting Holes								12.00
39 40 050 <sup>1)2)</sup>	4	506.67	14.2	38	40	39	35	2	62.5	125	4	12	10	15	9	33.3	433.0	7.7	5.30	
39 41 050	4	506.67	14.2	38	40	39	35	2				without Mounting Holes								5.30
39 40 100 <sup>2)</sup>	4	1000.00	14.2	75	40	39	35	2	62.5	125	8	12	10	15	9	33.3	933.4	7.7	10.50	
39 41 100	4	1000.00	14.2	75	40	39	35	2				without Mounting Holes								10.50
39 42 100	4	1000.00	14.2	75	40	39	35	2	62.5	125	8	12	14	20	13	33.3	933.4	11.7	10.50	
39 42 150 <sup>1)</sup>	4	1506.67	14.2	113	40	39	35	2	62.5	125	12	12	14	20	13	33.3	1433.4	11.7	15.75	
39 40 200	4	2000.00	14.2	150	40	39	35	2	62.5	125	16	12	10	15	9	33.3	1933.4	7.7	21.00	
39 41 200	4	2000.00	14.2	150	40	39	35	2				without Mounting Holes								21.00
39 42 200	4	2000.00	14.2	150	40	39	35	2	62.5	125	16	12	14	20	13	33.3	1933.4	11.7	21.00	
39 50 050 <sup>2)</sup>	5	500.00	17.7	30	50	39	34	2.5	62.5	125	4	12	14	20	13	37.5	425.0	11.7	6.50	
39 51 050	5	500.00	17.7	30	50	39	34	2.5				without Mounting Holes								6.50
39 50 100	5	1000.00	17.7	60	50	39	34	2.5	62.5	125	8	12	14	20	13	37.5	925.0	11.7	13.00	
39 51 100	5	1000.00	17.7	60	50	39	34	2.5				without Mounting Holes								13.00
39 50 200	5	2000.00	17.7	120	50	39	34	2.5	62.5	125	16	12	14	20	13	37.5	1925.0	11.7	26.00	
39 51 200	5	2000.00	17.7	120	50	39	34	2.5				without Mounting Holes								26.00
39 60 050 <sup>2)</sup>	6	500.00	21.4	25	60	49	43	2.5	62.5	125	4	16	18	26	17	37.5	425.0	15.7	9.90	
39 61 050	6	500.00	21.4	25	60	49	43	2.5				without Mounting Holes								9.90
39 60 100	6	1000.00	21.4	50	60	49	43	2.5	62.5	125	8	16	18	26	17	37.5	925.0	15.7	19.80	
39 61 100	6	1000.00	21.4	50	60	49	43	2.5				without Mounting Holes								19.80
39 60 200	6	2000.00	21.4	100	60	49	43	2.5	62.5	125	16	16	18	26	17	37.5	1925.0	15.7	39.60	
39 61 200	6	2000.00	21.4	100	60	49	43	2.5				without Mounting Holes								39.60

- 1) These racks should be used for continuous linking only with the left side (see sketch).
- 2) The screw joint limits the feed force.

**Total pitch error  $GT_f/1000 \leq 0.200$  mm.**

- Milled teeth and induction hardened
- Material C45
- Backside machined, profile blasted

**Further information see page ZA-13.**



**Quality 10**

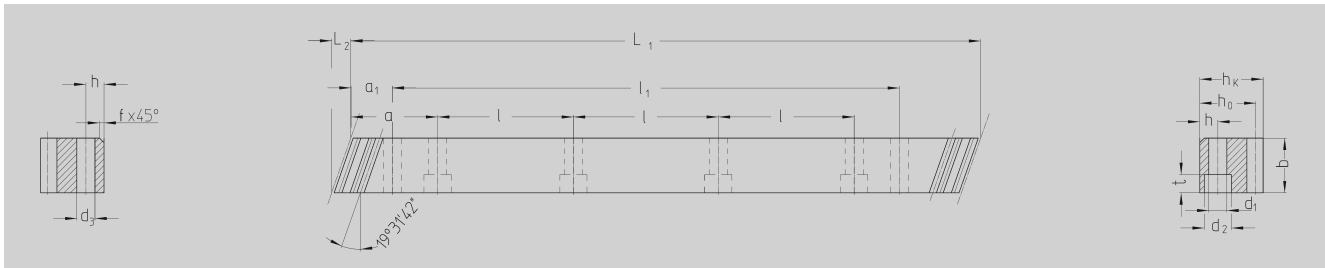

Order Code	Module	L <sub>1</sub>	L <sub>2</sub>	N° of Teeth	b	h <sub>k</sub>	h <sub>0</sub>	f	a	l	N° of Holes	h	d <sub>1</sub>	d <sub>2</sub>	t	a <sub>1</sub>	l <sub>1</sub>	d <sub>3</sub>	kg
<b>39 80 050</b> <sup>2)</sup>	8	480.00	28.4	18	80	79	71	2.5	60.0	120	4	25	22	33	21	120.0	240	19.7	21.00
<b>39 81 050</b>	8	480.00	28.4	18	80	79	71	2.5					without Mounting Holes						21.00
<b>39 80 100</b>	8	960.00	28.4	36	80	79	71	2.5	60.0	120	8	25	22	33	21	120.0	720	19.7	42.50
<b>39 81 100</b>	8	960.00	28.4	36	80	79	71	2.5					without Mounting Holes						42.50
<b>39 80 200</b>	8	1920.00	28.4	72	80	79	71	2.5	60.0	120	16	25	22	33	21	120.0	1680	19.7	85.00
<b>39 81 200</b>	8	1920.00	28.4	72	80	79	71	2.5					without Mounting Holes						85.00
<b>39 10 100</b>	10	1000.00	35.46	30	100	99	89	2.5	62.5	125	8	32	33	48	32	125.0	750	19.7	68.72
<b>39 11 100</b>	10	1000.00	35.46	30	100	99	89	2.5					without Mounting Holes						68.72
<b>39 12 100</b>	12	1000.00	42.56	25	120	120	108	2.5	40.0	125	8	40	39	58	38	102.5	750	19.7	120.00
<b>39 13 100</b>	12	1000.00	42.56	25	120	120	108	2.5					without Mounting Holes						120.00

- 1) These racks should be used for continuous linking only with the left side (see sketch).
- 2) The screw joint limits the feed force.

**Total pitch error  $GT_f / 1000 \leq 0.200$  mm.**

- Milled teeth and induction hardened
- Material C45
- Backside machined, profile blasted

**Mounting racks, see page ZF-2.**

**To achieve precision rack joints, we recommend our patented rack assembly kit, see page ZF-4.**

**For lubrication of racks & pinions, we recommend our automatic lubrication systems, see page ZE-1.**

**For the calculation and selection of the rack & pinion drive, see page ZD-1.**

**Screws for rack mounting, see page ZF-3.**

