

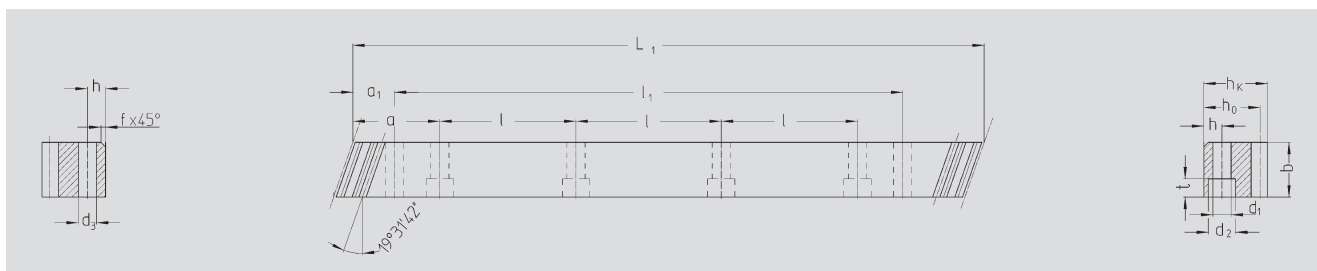

**ATLANTA-Quality 3**



Order Code	Module	L <sub>1</sub>	N° of teeth	b <sup>+0.4</sup>	h <sub>k</sub>	h <sub>0</sub>	f	a	l	N° of holes	h	d <sub>1</sub>	d <sub>2</sub>	t	a <sub>1</sub>	l <sub>1</sub>	d <sub>3</sub>	kg
48 50 105	5	1000.00	60	49	39	34	2.5	62.5	125	8	12	13.5	20	13	37.5	925	11.7	12.15
48 60 105	6	1000.00	50	59	49	43	2.5	62.5	125	8	16	17.5	26	17	37.5	925	15.7	18.10
48 80 105	8	960.00	36	79	79	71	2.5	60.0	120	8	25	22.0	33	21	120.0	720	19.7	42.50
48 10 105	10	1000.00	30	99	99	89	2.5	62.5	125	8	32	33.0	48	32	125.0	750	19.7	68.70
48 12 105	12	1000.00	25	120	120	108	2.5	40.0	125	8	40	39.0	58	38	102.5	750	19.7	111.00

**Total pitch error**  $GT_f/1000 \leq 0.012 \text{ mm}$

- Teeth hardened with the ATLANTA high performance hardening process and ground
- Heat-treatable steel according to ATLANTA-Standard
- Ground on all sides after hardening
- Signed with effective total pitch error (20°C)

Inspection measurement data available as an option.

To achieve precision rack joints, we recommend our patented rack assembly kit, see page ZF-4.

For lubrication of racks & pinions, we recommend our automatic lubrication systems, see page ZE-1.

For the calculation and selection of the rack & pinion drive, see page ZD-1.

Screws for rack mounting, see page ZF-3.

