

Input speed ( $n_1$ ) = 1400 min<sup>-1</sup>

Output speed $n_2$ [min <sup>-1</sup> ]	Ratio $i$	Motor power $P_{1M}$ [kW]	Output torque $M_{2M}$ [Nm]	Service factor $f.s$	Nominal power $P_{1R}$ [kW]	Nominal torque $M_{2R}$ [Nm]	B5 motor flanges		B14 motor flanges		Dynamic efficiency RD	Tooth module [mm]	Ratio code
							-A 56	-B 63	-O 56	-P 63			
10.0	140	0.12	57	1.2	0.14	69	B		B-C		50	2.2	01
7.0	200	0.12	79	0.9	0.11	69	B		B-C		48	2.2	02
5.0	280	0.06	52	1.3	0.08	69	B		B-C		45	2.4	03
3.3	420	0.06	62	1.1	0.07	69	B		B-C		36	1.6	04
2.5	560	0.06	76	0.9	0.05	69	B		B-C		33	2.5	05
1.9	740	0.06	91	0.8	0.05	69	B		B-C		30	1.8	06
1.5	920	0.06*	69	<0.8	0.04	69	B		B-C		27	1.5	07
1.3	1120	0.06*	69	<0.8	0.03	69	B		B-C		26	2.5	08
0.9	1480	0.06*	69	<0.8	0.03	69	B		B-C		24	1.8	09
0.8	1840	0.06*	69	<0.8	0.02	69	B		B-C		22	1.5	10
0.6	2400	0.06*	69	<0.8	0.02	69	B		B-C		21	1.2	11

\* Power higher than the maximum one which can be supported by the gearbox. Select according to the torque  $M_{2R}$   
*Potenza superiore a quella massima sopportabile dal riduttore. Selezionare in base al momento torcente  $M_{2R}$*

**Motor flanges available**  
*Flange motore disponibili*



**B) Supplied with reduction bushing**  
*Fornito con bussola di riduzione*



**B) Available on request without reduction bushing**  
*Disponibile a richiesta senza bussola di riduzione*



**C) Motor flange holes position**  
*Posizione fori flangia motore*

## Lubrication

*Lubrificazione*

Unit 4D3 is supplied with synthetic oil to assure long life lubrication. Food grade oil is available on request. See Table 1 for lubrication and recommended quantity. See Table 2 for possible radial and axial loads on the gearbox.

*Il riduttore tipo 4D3 viene fornito con olio sintetico e lubrificazione tipo "long life". Disponibile a richiesta olio alimentare. Vedi Tabella 1 per oli e quantità consigliati. Vedi Tabella 2 per i carichi radiali e assiali applicabili al riduttore.*

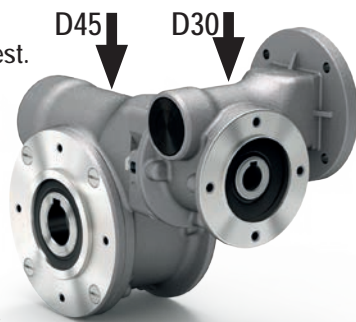

D45: 0.09 L

Shell

Omala S4 WE 320

Eni

Telium VSF 320

For all details on lubrication and plugs check our website.  
*Per maggiori dettagli su lubrificazione e tappi olio vedi il nostro sito web.*

Tab. 1

## Suggested

*Suggerito*

Stainless steel protection cap (on request).

*Coperchio di protezione in acciaio inox a richiesta.*

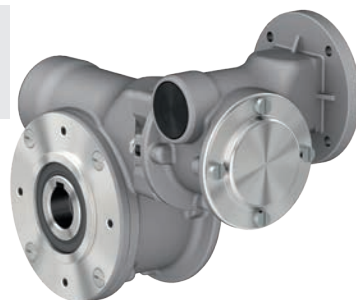

Kit cod. KN300209

## Radial and axial loads

*Carichi radiali e assiali*

### Output shaft

*Albero di uscita*

$n_2$ [min <sup>-1</sup> ]	FA [N]	FR [N]
25	300	1800
15	400	2000

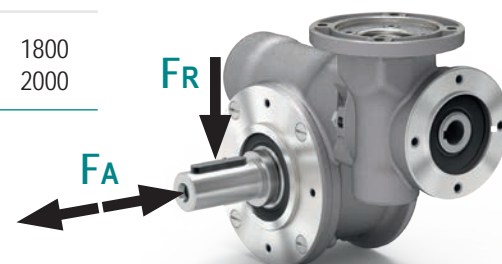

### Input shaft

*Albero in entrata*

$n_1$ [min <sup>-1</sup> ]	FA [N]	FR [N]
1400	20	100

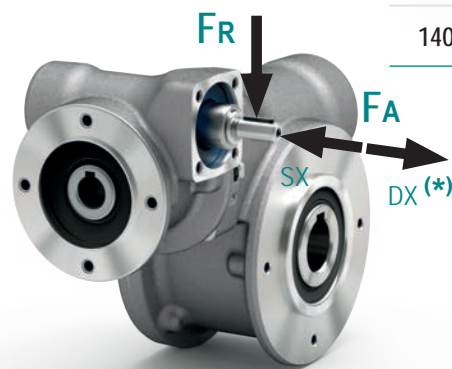

\* Strong axial loads in the DX direction are not allowed.

*\* Non sono consentiti forti carichi assiali con direzione DX*

Tab. 2

**P4D3UNI.. Basic gearbox**  
*Riduttore base*

M. flanges	Kit code	øF	A
56B5	KD304041	120	62
63B5	KD304042	140	63
56B14	KD304046	80	62
63B14	KD304045	90	63

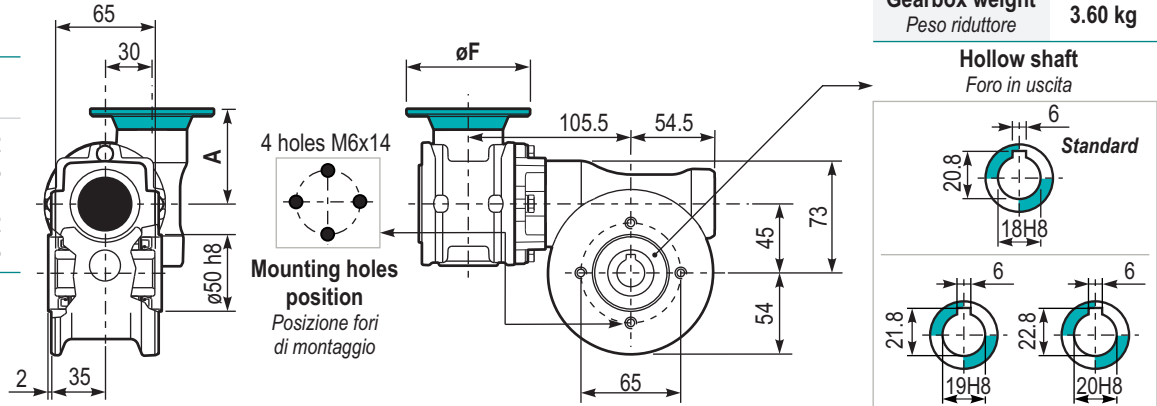

**Gearbox weight**  
*Peso riduttore* **3.60 kg**

**Hollow shaft**  
*Foro in uscita*

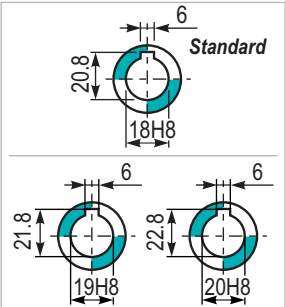

**P4D3PA... Feet**  
*Piedini*

Type	T	Kit code
B**	102	K0459022
I*	100	KN459022

\*\* Zink plated  
\* Stainless steel

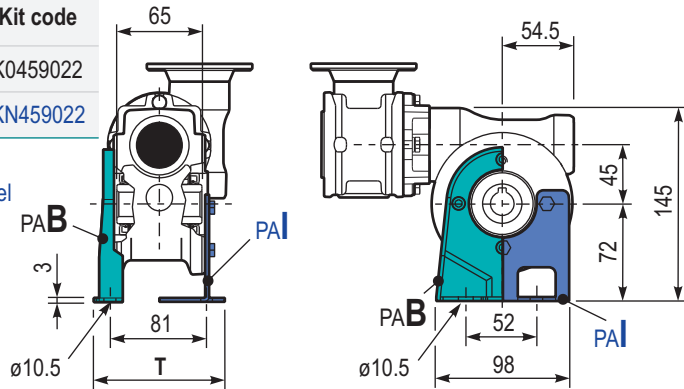

**P4D3PBB... Feet**  
*Piedini*

**P4D3PV... Feet**  
*Piedini*

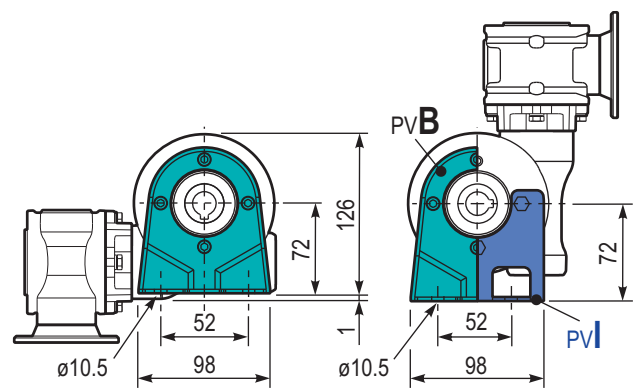

**P4D3FL... Output flange**  
*Flangia uscita*

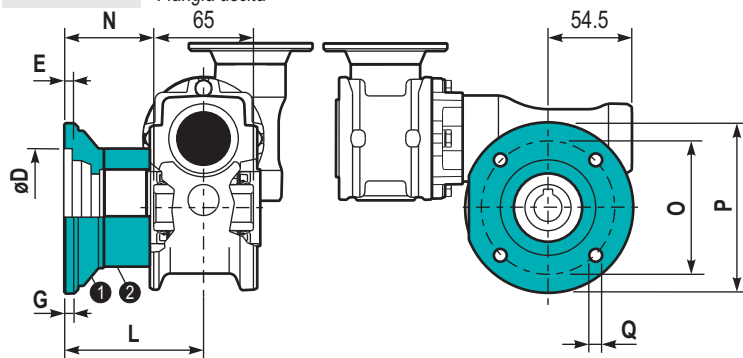

Type	øD	E	G	L	N	O	P	Q	Kit code
C	60 <sup>+0.15</sup> / <sub>+0.05</sub>	9	9	60.5	28	87	110	8.5	① K0459010 ② - ③ K0450200
L	60 <sup>+0.15</sup> / <sub>+0.05</sub>	9	9	90.5	58	87	110	8.5	① K0459010 ② K0450200

**P4D3BR... Reaction arm**  
*Braccio di reazione*

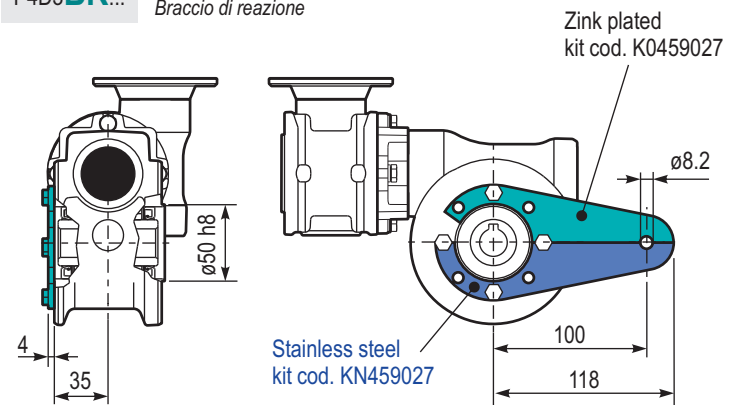

**R4D3UNI... Input shaft**  
*Albero in entrata*

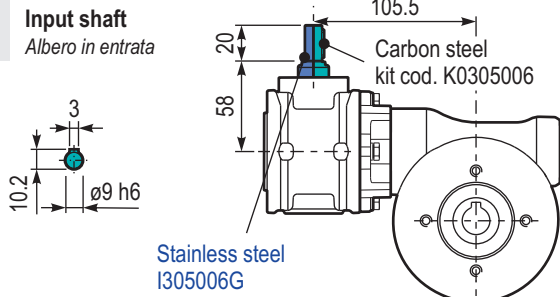

**P4D3..SMB Single output shaft**  
*Albero semplice in uscita*

