

Input speed ( $n_1$ ) = 1400 min<sup>-1</sup>

Output speed $n_2$ [min <sup>-1</sup> ]	Ratio $i$	Motor power $P_{1M}$ [kW]	Output torque $M_{2M}$ [Nm]	Service factor $f.s$	Nominal power $P_{1R}$ [kW]	Nominal torque $M_{2R}$ [Nm]	B5 motor flanges			B14 motor flanges			Dynamic efficiency RD	Tooth module [mm]	Ratios code
							-	-	-	-R	-T	-U			
200	7	4.0	168	1.5	6.1	257	-	-	-	B	B		88	4.23	01
140	10	4.0	218	1.3	5.2	284	-	-	-	B	B		80	4.2	02
100	14	3.0	223	1.4	4.1	305	-	-	-	B	B		78	4.5	03
70	20	2.2	237	1.2	2.7	294	-	-	-	B	B		79	3.4	04
64	22	2.2	258	1.1	2.5	294	-	-	-	B	B		78	3.1	05
50	28	2.2	315	1.1	2.4	347	-	-	-	B	B		75	4.7	06
37	38	1.5	276	1.2	1.8	336	-	-	-	B	B		71	3.5	07
30	46	1.5	320	1.0	1.5	326	-	-	-	B			68	3.1	08
27	52	1.1	258	1.1	1.2	289	-	-	-	B			66	2.7	09
21	67	1.1	327	0.9	0.97	289	-	-	-	B			65	2.1	10
18.9	74	0.75	220	1.2	0.91	268	-	-	-	B			58	1.9	11
14.6	96	0.55	191	1.3	0.70	242	-	-	-	B			53	1.5	12

**Motor flanges available**  
Flange motore disponibili



**B) Supplied with reduction bushing**  
Fornito con bussola di riduzione



**B) Available on request without reduction bushing**  
Disponibile a richiesta senza bussola di riduzione



**C) Motor flange holes position**  
Posizione fori flangia motore

## Lubrication

Lubrificazione

Unit I85 is supplied with synthetic oil to assure long life lubrication. Food grade oil is available on request. See Table 1 for lubrication and recommended quantity. See Table 2 for possible radial and axial loads on the gearbox.

Il riduttore tipo I85 viene fornito con olio sintetico e lubrificazione tipo "long life". Disponibile a richiesta olio alimentare. Vedi Tabella 1 per oli e quantità consigliati. Vedi Tabella 2 per i carichi radiali e assiali applicabili al riduttore.

Shell Omala S4 WE 320

Eni Telium VSF 320

**B3**  
Standard  
1.40 L

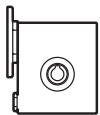

**B8**  
On request  
1.40 L

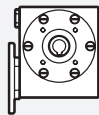

**B6**  
On request  
1.40 L

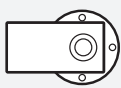

**V5**  
On request  
1.40 L

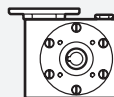

**B7**  
On request  
1.70 L

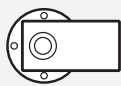

**V6**  
On request  
1.40 L

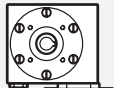

For more details on lubrication and plugs check our website.  
Per maggiori dettagli su lubrificazione e tappi olio vedi il nostro sito web.

Tab. 1

## Suggested Sugerito

Stainless steel protection cap (on request).  
Coperchio di protezione in acciaio inox a richiesta.

Kit cod. KI850211



## Radial and axial loads

Carichi radiali e assiali

### Output shaft

Albero di uscita

$n_2$ [min <sup>-1</sup> ]	FA [N]	FR [N]
200	500	2500
150	580	2900
100	600	3000
75	700	3500
50	800	4000
25	1000	5000
15	1160	5800

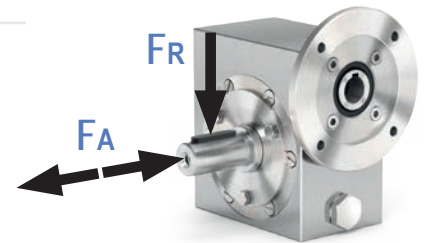

### Input shaft

Albero in entrata

$n_1$ [min <sup>-1</sup> ]	FA [N]	FR [N]
1400	130	650

\* Strong axial loads in the DX direction are not allowed.  
\* Non sono consentiti forti carichi assiali con direzione DX

Tab. 2

PI85UNI... **Basic gearbox**  
Riduttore base

Gearbox weight **23.3 kg**  
peso riduttore

M. flanges	Kit code	øF	A
80B14	KI854046	120	118
90B14	KI854045	140	118
100-112B14	KI854041	160	127

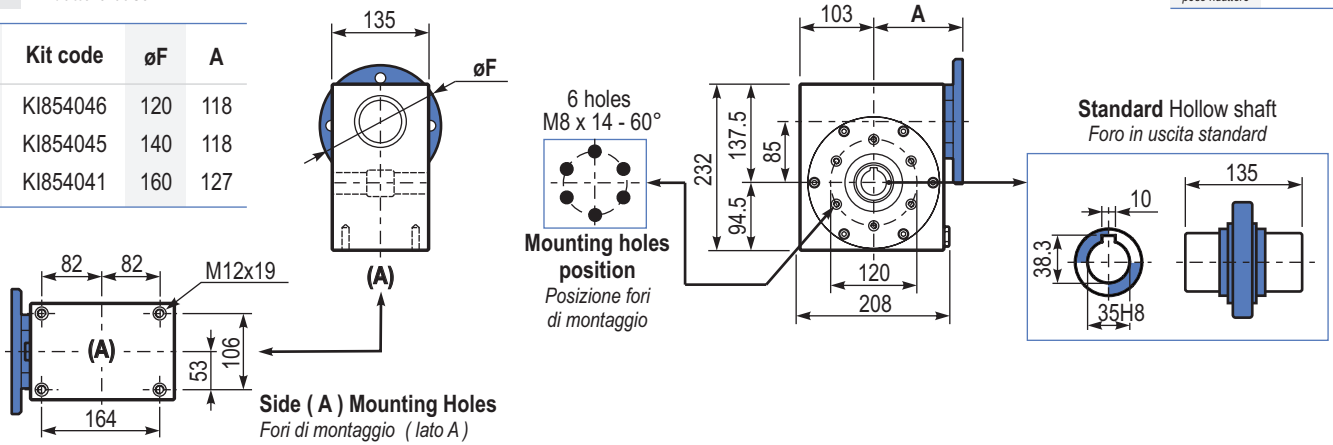

B185UNI... **Modular base**  
Base modulare

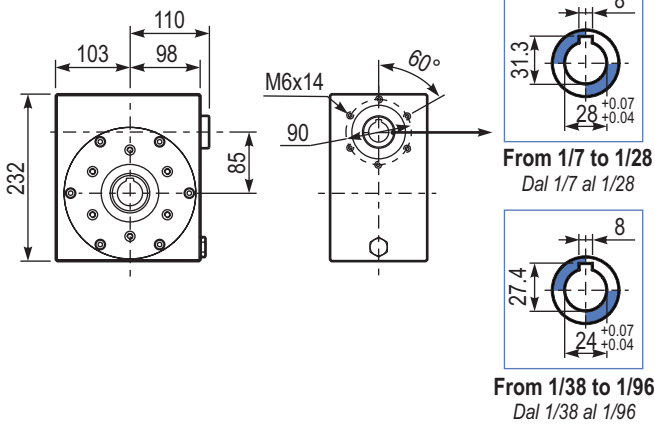

PI85FLL... **Output flange**  
Flangia uscita

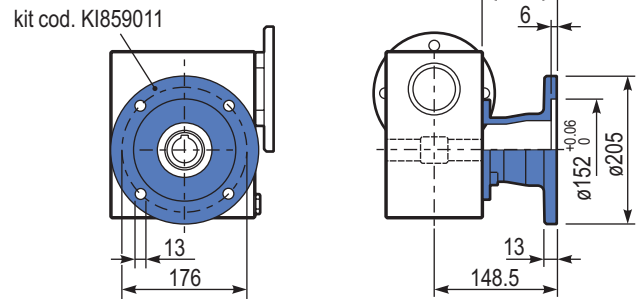

R185UNI... **Input shaft**  
Albero in entrata

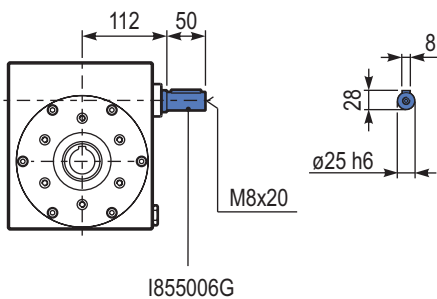

PI85BRI... **Reaction arm**  
Braccio di reazione

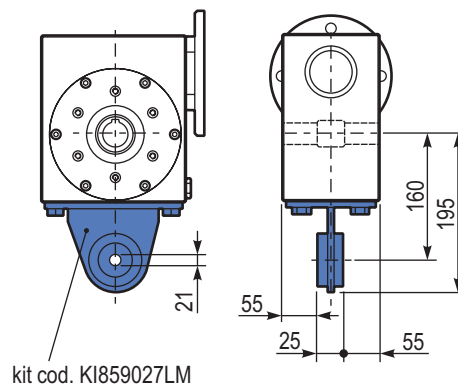

PI85...SMK... **Single Shaft**  
Albero lento semplice

