

Input speed ( $n_1$ ) = 1750 min<sup>-1</sup>

Output speed $n_2$ [min <sup>-1</sup> ]	Ratio $i$	Motor power $P_{1M}$ [HP]	Output torque $M_{2M}$ [lb in]	Service factor $f.s$	Nominal power $P_{1R}$ [HP]	Nominal torque $M_{2R}$ [lb in]	Available NEMA motor flanges			Dynamic efficiency RD	Tooth module [mm]	Ratio code
							-W 56C	-X 143-5TC	-Y 182-4TC			
250.0	7	5	1109	2.0	9.90	2168	B	B		88	4.23	01
175.0	10	5	1441	1.7	8.40	2390	B	B		80	4.2	02
125.0	14	5	1967	1.3	6.61	2567	B	B		78	4.5	03
87.5	20	3	1707	1.5	4.41	2478	B	B		79	3.4	04
79.5	22	3	1854	1.3	4.06	2478	B	B		78	3.1	05
62.5	28	3	2269	1.3	3.91	2921	B	B		75	4.7	06
46.1	38	3	2915	1.0	2.95	2832	B	B		71	3.5	07
38.0	46	2	2253	1.2	2.47	2744	B	B		68	3.1	08
33.7	52	2	2472	1.0	1.99	2434	B	B		66	2.7	09
26.1	67	1.5	2353	1.0	1.57	2434	B	B		65	2.1	10
23.6	74	1.5	2319	1.0	1.48	2257	B	B		58	1.9	11
18.2	96	1	1833	1.1	1.13	2036	B	B		53	1.5	12

**Motor flanges available**  
Flange motore disponibili



**B) Supplied with reduction bushing**  
Fornito con bussola di riduzione



**B) Available on request without reduction bushing**  
Disponibile a richiesta senza bussola di riduzione



**C) Motor flange holes position**  
Posizione fori flangia motore

## Lubrication

Lubrificazione

Unit D85 is supplied with synthetic oil to assure long life lubrication. Food grade oil is available on request. See Table 1 for lubrication and recommended quantity. See Table 2 for possible radial and axial loads on the gearbox.

Il riduttore tipo D85 viene fornito con olio sintetico e lubrificazione tipo "long life". Disponibile a richiesta olio alimentare. Vedi Tabella 1 per oli e quantità consigliati. Vedi Tabella 2 per i carichi radiali e assiali applicabili al riduttore.

**Oil quantity for all positions:**  
42.23 oz.

Quantità olio per tutte le posizioni: 42.23 oz.

**Shell**  
Omala S4 WE 320

**Eni**  
Telium VSF 320

Tab. 1

## Suggested

Suggerito

**Stainless steel protection cap (on request).**

Coperchio di protezione in acciaio inox a richiesta.

Kit cod. KN850209

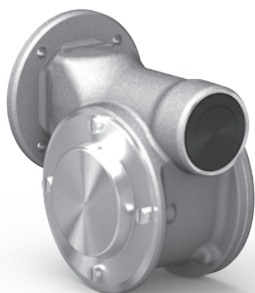

## Radial and axial loads

Carichi radiali e assiali

### Output shaft

Albero di uscita

$n_2$ [min <sup>-1</sup> ]	FA [lb]	FR [lb]
200	112	562
150	130	652
100	135	674
75	157	787
50	180	899
25	225	1124
15	261	1304

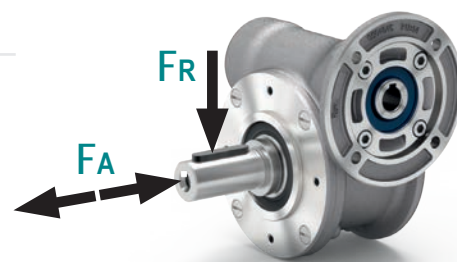

### Input shaft

Albero in entrata

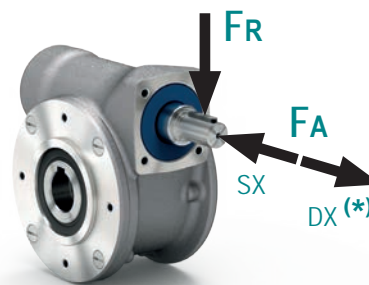

$n_1$ [min <sup>-1</sup> ]	FA [lb]	FR [lb]
1750	36	182

\* Strong axial loads in the DX direction are not allowed.

\* Non sono consentiti forti carichi assiali con direzione DX

Tab. 2

PD85 **UNI..** Basic gearbox  
Riduttore base

M. flanges	Kit code	øF	A
56C	KUD854041	6.50	4.823
143/5 TC	KUD854041	6.50	4.823
182/4 TC	KUD854042	8.88	5.527

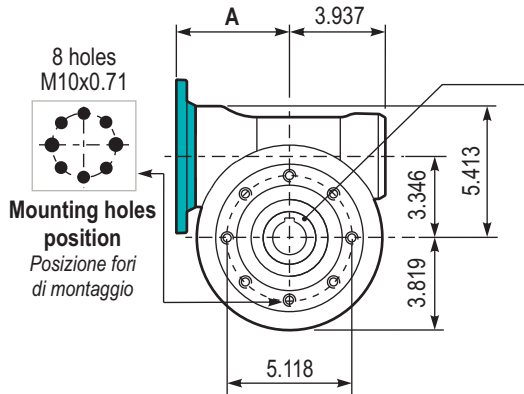
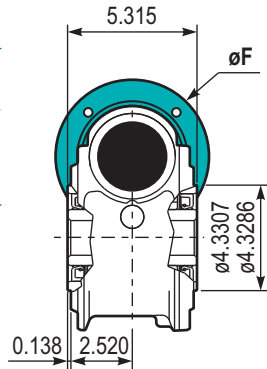

Gearbox weight  
Peso riduttore 24.25 lb

Hollow shaft  
Foro in uscita

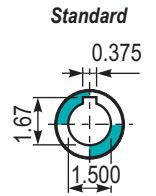

PD85 **PA...** Feet  
Piedini

Type	T	V	Kit code
B**	7.165	7.087	K0859022
I*	6.929	6.772	KN859022

\*\* Zink plated  
\* Stainless steel

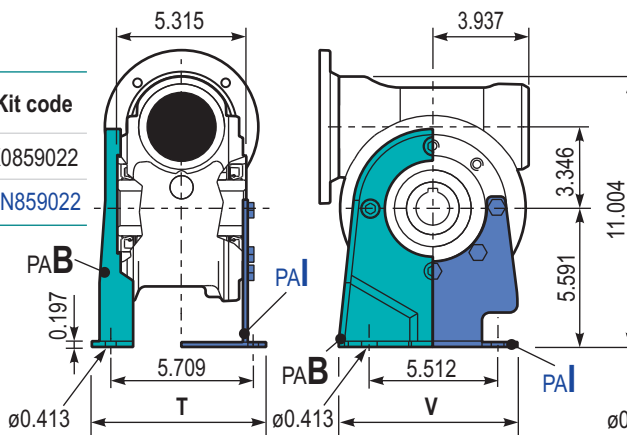

PD85 **PBB..** Feet  
Piedini

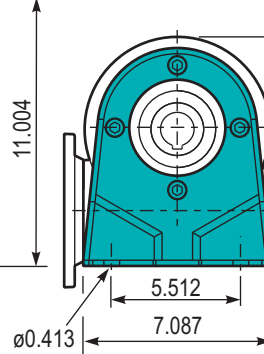

PD85 **PV...** Feet  
Piedini

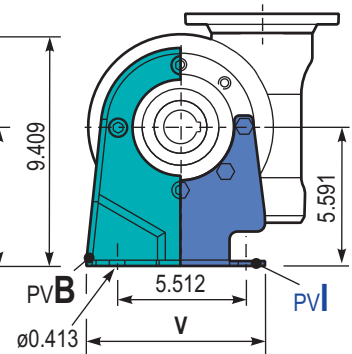

PD85 **FL..** Output flange  
Flangia uscita

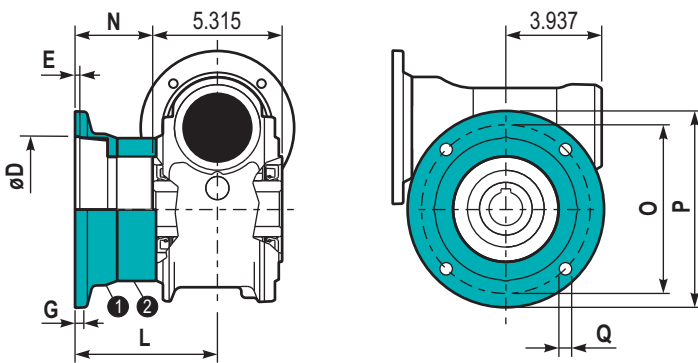

Type	øD	E	G	L	N	O	P	Q	Kit code
C	5.9867	0.20	0.63	4.252	1.594	6.929	8.071	0.51	① K0859010
	5.9843								② -
L	5.9867	0.20	0.63	5.846	3.189	6.929	8.071	0.51	③ K0859010
	5.9843								④ K0850201

PD85 **BR...** Reaction arm  
Braccio di reazione

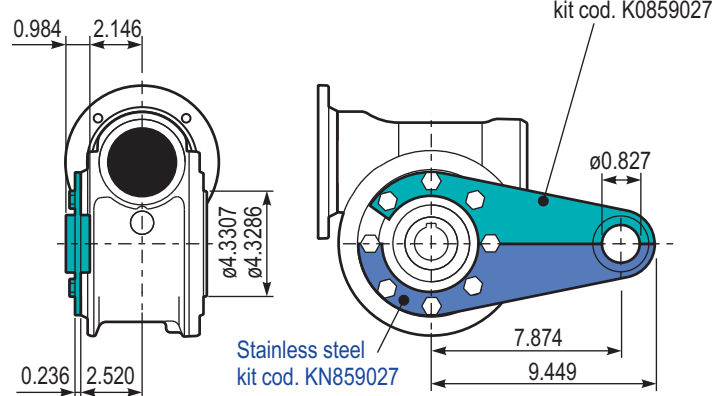

RD85 **UNI..** Input shaft  
Albero in entrata

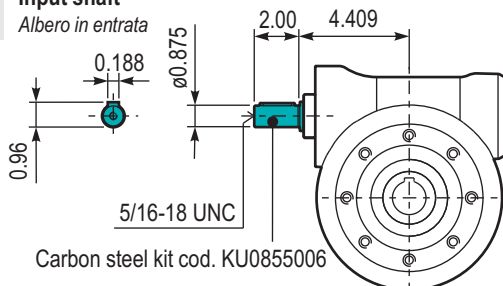

PD85.. **SIH** Single output shaft  
Albero semplice in uscita

