

Input speed ( $n_1$ ) = 1750 min<sup>-1</sup>

Output speed $n_2$ [min <sup>-1</sup> ]	Ratio $i$	Motor power $P_{1M}$ [HP]	Output torque $M_{2M}$ [lb in]	Service factor f.s	Nominal power $P_{1R}$ [HP]	Nominal torque $M_{2R}$ [lb in]	Available NEMA motor flanges			Dynamic efficiency RD	Tooth module [mm]	Ratios code
							-X 143-5TC	-Y 182-4TC	AA 213-5TC			
250	7	10	2219	1.8	18.59	4071	B			88	5.5	01
175	10	10	3097	1.4	14.48	4425	B			86	5.4	02
109.4	16	10	4725	1.0	9.68	4514	B			82	5.3	03
87.5	20	7.5	4430	1.0	7.89	4602	B			82	4.5	04
76.1	23	5	3314	1.3	6.63	4337	B			80	3.9	05
58.3	30	5	4106	1.3	6.77	5487	B			76	5.6	06
46.1	38	5	5132	1.1	5.33	5399	B			75	4.7	07
38.9	45	3	3549	1.4	4.32	5045	B			73	4.0	08
33.0	53	3	4009	1.3	3.96	5222	B			70	3.5	09
27.3	64	2	3181	1.4	2.88	4514	B			69	2.9	10
20.8	84	2	3933	1.1	2.14	4160	B			65	2.2	11
17.7	99	2	4279	1.0	1.93	4071	B			60	1.9	12

The nominal power should be reduced if the ambient temperature is  $\geq 30^\circ\text{C}$ , or when a cooler gearbox is required.  
 Diminuire la potenza nominale in caso di temperatura ambiente  $\geq 30^\circ\text{C}$  o se è richiesta una bassa temperatura di utilizzo del riduttore.

-  **Motor flanges available**  
Flange motore disponibili
-  **B) Supplied with reduction bushing**  
Fornito con bussola di riduzione
-  **B) Available on request without reduction bushing**  
Disponibile a richiesta senza bussola di riduzione
-  **C) Motor flange holes position**  
Posizione fori flangia motore

## Lubrication Lubrificazione

Unit I11 is supplied with synthetic oil to assure long life lubrication.  
 Food grade oil is available on request.  
 See Table 1 for lubrication and recommended quantity.  
 See Table 2 for possible radial and axial loads on the gearbox.

Il riduttore tipo I11 viene fornito con olio sintetico e lubrificazione tipo "long life".  
 Disponibile a richiesta olio alimentare.  
 Vedi Tabella 1 per oli e quantità consigliati.  
 Vedi Tabella 2 per i carichi radiali e assiali applicabili al riduttore.

**Shell** Omala S4 WE 320  
**Eni** Telium VSF 320

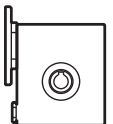
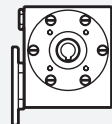
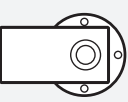
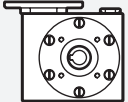
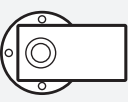
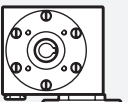
<b>B3</b> Standard 123.2 oz		<b>B8</b> On request 73.9 oz	
<b>B6</b> On request 88 oz		<b>V5</b> On request 56.3 oz	
<b>B7</b> On request 88 oz		<b>V6</b> On request 56.3 oz	

For more details on lubrication and plugs check our website.  
 Per maggiori dettagli su lubrificazione e tappi olio vedi il nostro sito web.

Tab. 1

## Radial and axial loads Carichi radiali e assiali

### Output shaft Albero di uscita

$n_2$ [min <sup>-1</sup> ]	$F_A$ [lb]	$F_R$ [lb]
200	135	652
150	157	742
100	169	809
75	180	899
50	207	1034
25	270	1349
15	315	1574

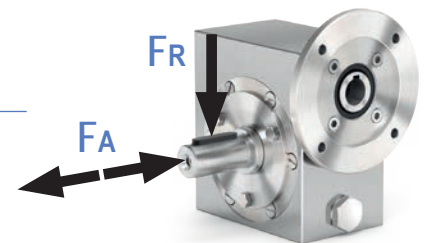

Tab. 2

PI11 **UNI...** **Basic gearbox**  
*Riduttore base*

Gearbox weight  
peso riduttore **88.0 lb**

M. flanges	Kit code	øF	A
143/5 TC	KUI854041	6.50	5.591
182/4 TC	KUI854042	8.88	6.295
213/5 TC	-	8.88	7.358

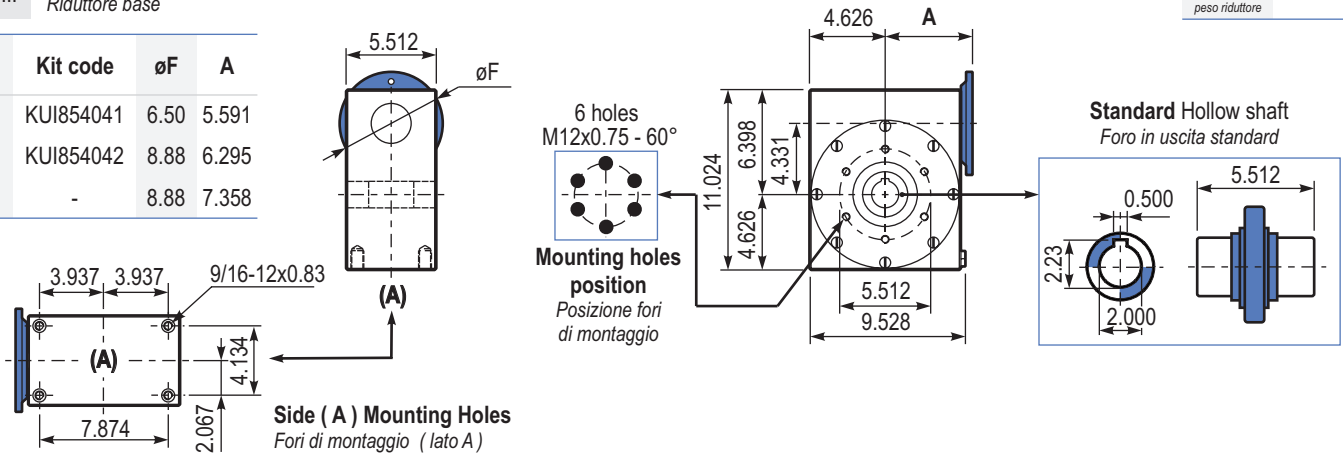

B111 **UNI...** **Modular base**  
*Base modulare*

PI11 **BRI...** **Reaction arm**  
*Braccio di reazione*

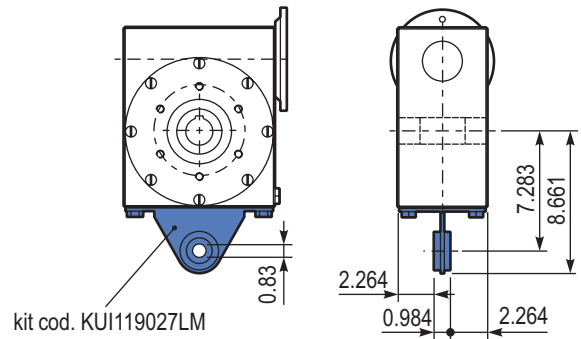
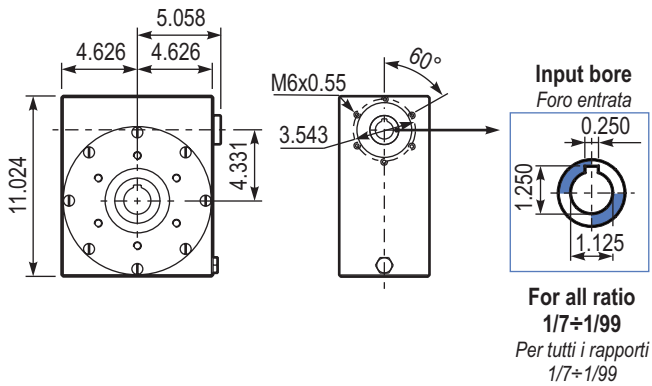

PI11... **SIK** **Single Shaft**  
*Albero lento semplice*

kit cod. KI110211  
**Protection cup (on request)**  
*A richiesta coperchio di protezione*

