



Input speed (n_1) = 1750 min⁻¹

Output speed n_2 [min ⁻¹]	Ratio i	Motor power P_{1M} [HP]	Output torque M_{2M} [lb in]	Service factor $f.s$	Nominal power P_{1R} [HP]	Nominal torque M_{2R} [lb in]	Available NEMA motor flanges		Dynamic efficiency RD	Tooth module  [mm]	Ratios code 
							-W 56C	-			
250.0	7	1	202	1.3	1.29	257			80	2.2	01
175.0	10	0.75	213	1.2	0.91	257			79	2.2	02
125.0	14	0.5	194	1.3	0.67	257			77	2.4	03
83.3	21	0.5	253	1.4	0.69	345			67	1.6	04
62.5	28	0.5	328	1.1	0.53	345			65	2.5	05
47.3	37	0.33	277	1.2	0.42	345			63	1.8	06
38.0	46	0.33	323	1.1	0.36	345			59	1.5	07
29.2	60	0.25	303	1.1	0.29	345			56	1.2	08
25.0	70	0.25	340	0.8	0.19	257			54	1.0	09
17.2	102	0.25*	450	<0.8	0.14	248			49	0.72	10

* Power higher than the maximum one which can be supported by the gearbox. Select according to the torque M_{2R}

* Potenza superiore a quella massima supportabile dal riduttore. Selezionare in base al momento torcente M_{2R}

The nominal power should be reduced if the ambient temperature is $\geq 30^\circ\text{C}$, or when a cooler gearbox is required.

Diminuire la potenza nominale in caso di temperatura ambiente $\geq 30^\circ\text{C}$ o se è richiesta una bassa temperatura di utilizzo del riduttore.

-  **Motor flanges available**
Flange motore disponibili
-  **B) Supplied with reduction bushing**
Fornito con bussola di riduzione
- B) Available on request without reduction bushing**
Disponibile a richiesta senza bussola di riduzione
-  **C) Motor flange holes position**
Posizione fori flangia motore

Lubrication Lubrificazione

Unit I45 is supplied with synthetic oil to assure long life lubrication.
Food grade oil is available on request.
See Table 1 for lubrication and recommended quantity.
See Table 2 for possible radial and axial loads on the gearbox.

Il riduttore tipo I45 viene fornito con olio sintetico e lubrificazione tipo "long life".
Disponibile a richiesta olio alimentare.
Vedi Tabella 1 per oli e quantità consigliati.
Vedi Tabella 2 per i carichi radiali e assiali applicabili al riduttore.

Shell Omala S4 WE 320
Eni Telium VSF 320

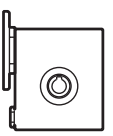
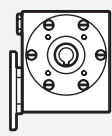
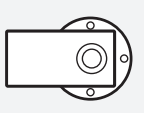
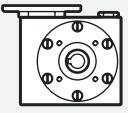
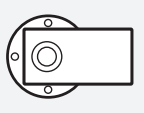
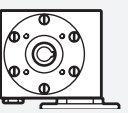
B3 Standard 5.28 oz 	B8 On request 5.28 oz 
B6 On request 5.28 oz 	V5 On request 5.28 oz 
B7 On request 7.04 oz 	V6 On request 5.28 oz 

For more details on lubrication and plugs check our website.
Per maggiori dettagli su lubrificazione e tappi olio vedi il nostro sito web.

Tab. 1

Radial and axial loads Carichi radiali e assiali

Output shaft Albero di uscita

n_2 [min ⁻¹]	FA [lb]	FR [lb]
200	40	202
150	45	225
100	49	247
75	54	270
50	58	315
25	67	405
15	90	450

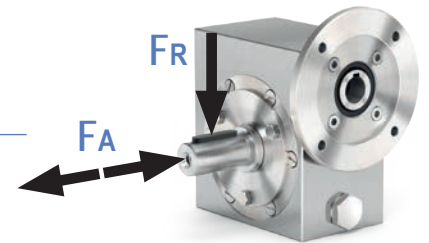

Tab. 2

Suggested Sugerito

Stainless steel protection cap
(on request).

Coperchio di protezione in
acciaio inox a richiesta.

Kit cod. KI450211



PI45UNI... Basic gearbox
Riduttore base

Gearbox weight
peso riduttore 11.0 lb

M. flanges	Kit code	øF	A
56C	KUI504041	6.5	3.689

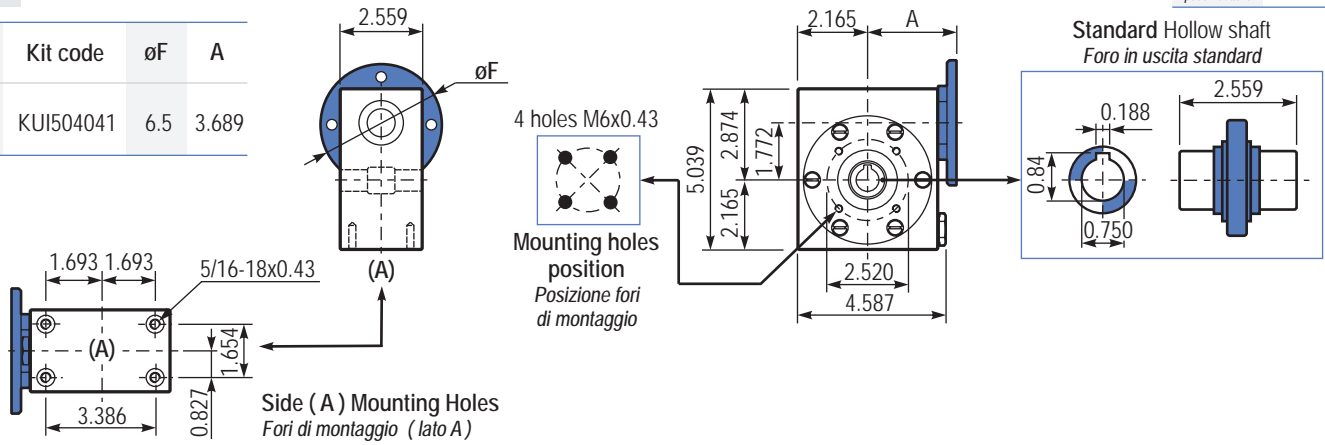

BI45UNI... Modular base
Base modulare

PI45FLL... Output flange
Flangia uscita

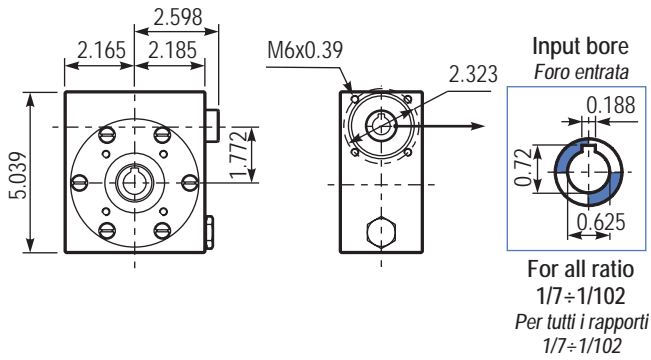

kit cod. KI459011

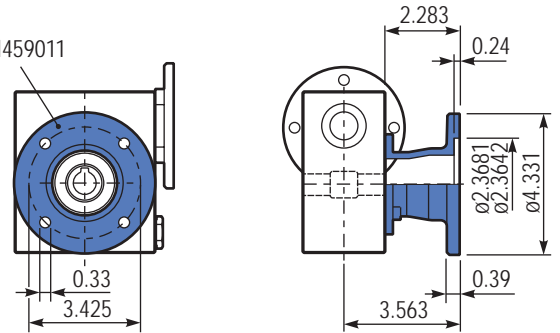

PI45BRI... Reaction arm
Braccio di reazione

PI45.....SIB Single Shaft
Albero lento semplice

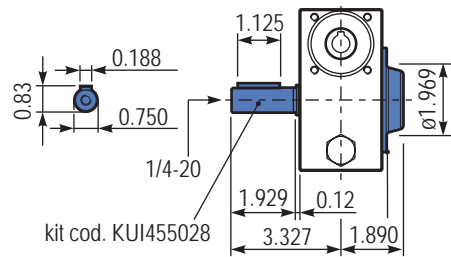
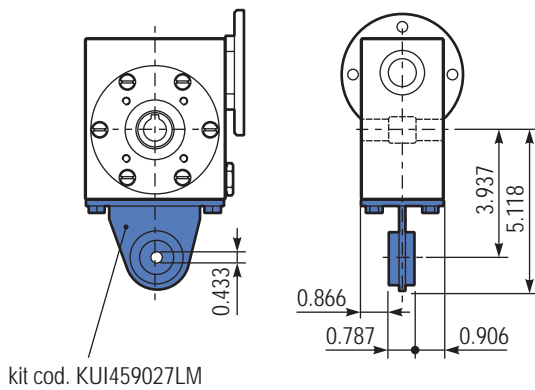

kit cod. KI450211
Protection cup
(on request)
A richiesta coperchio
di protezione