

Input speed (n_1) = 1750 min⁻¹

Output speed n_2 [min ⁻¹]	Ratio i	Motor power P_{1M} [HP]	Output torque M_{2M} [lb in]	Service factor $f.s$	Nominal power P_{1R} [HP]	Nominal torque M_{2R} [lb in]	Available NEMA motor flanges		Dynamic efficiency RD	Tooth module [mm]	Ratios code
							-W 56C	-			
250.0	7	2	413	1.2	2.34	478			82	2.5	01
175.0	10	1.5	432	1.2	1.84	522			80	2.4	02
125.0	14	1	398	1.4	1.46	575			79	2.6	03
97.2	18	1	486	1.1	1.09	522			75	2.0	04
67.3	26	0.75	485	1.2	0.87	558			69	2.7	05
58.3	30	0.75	567	1.1	0.82	611			70	2.5	12
48.6	36	0.5	447	1.4	0.69	611			69	2.1	06
40.7	43	0.5	511	1.1	0.57	575			66	1.8	07
35.0	50	0.5	558	1.0	0.51	558			62	1.5	13
29.2	60	0.33	414	1.3	0.42	522			58	1.3	08
25.7	68	0.33	461	1.1	0.35	487			57	1.2	09
21.9	80	0.25	389	1.2	0.31	478			54	1.0	10
17.5	100	0.25	450	1.0	0.24	434			50	0.8	11

The nominal power should be reduced if the ambient temperature is $\geq 30^\circ\text{C}$, or when a cooler gearbox is required.

Diminuire la potenza nominale in caso di temperatura ambiente $\geq 30^\circ\text{C}$ o se è richiesta una bassa temperatura di utilizzo del riduttore.

Motor flanges available
Flange motore disponibili



B) Supplied with reduction bushing
Fornito con bussola di riduzione



B) Available on request without reduction bushing
Disponibile a richiesta senza bussola di riduzione



C) Motor flange holes position
Posizione fori flangia motore

Lubrication

Lubrificazione

Unit I45 is supplied with synthetic oil to assure long life lubrication.

Food grade oil is available on request.

See Table 1 for lubrication and recommended quantity.

See Table 2 for possible radial and axial loads on the gearbox.

Il riduttore tipo I45 viene fornito con olio sintetico e lubrificazione tipo "long life".

Disponibile a richiesta olio alimentare.

Vedi Tabella 1 per oli e quantità consigliati.

Vedi Tabella 2 per i carichi radiali e assiali applicabili al riduttore.

Shell

Omala S4 WE 320

Eni

Telium VSF 320

B3

Standard
7.74 oz

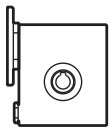

B8

On request
7.74 oz

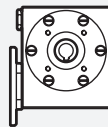

B6

On request
7.74 oz

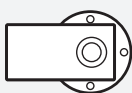

V5

On request
7.74 oz

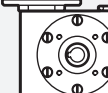

B7

On request
9.85 oz

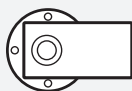

V6

On request
7.74 oz

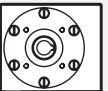

For more details on lubrication and plugs check our website.

Per maggiori dettagli su lubrificazione e tappi olio vedi il nostro sito web.

Tab. 1

Radial and axial loads

Carichi radiali e assiali

Output shaft

Albero di uscita

n_2 [min ⁻¹]	F_A [lb]	F_R [lb]
200	54	270
150	63	315
100	67	337
75	76	382
50	85	427
25	108	562
15	126	629

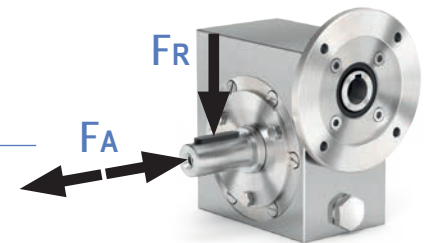

Tab. 2

Suggested

Suggerito

Stainless steel protection cap
(on request).

Coperchio di protezione in
acciaio inox a richiesta.

Kit cod. KI500211



PI50 **UNI...** Basic gearbox
Riduttore base

Gearbox weight
peso riduttore **16.1 lb**

M. flanges	Kit code	øF	A
56C	KUI504041	6.5	3.866

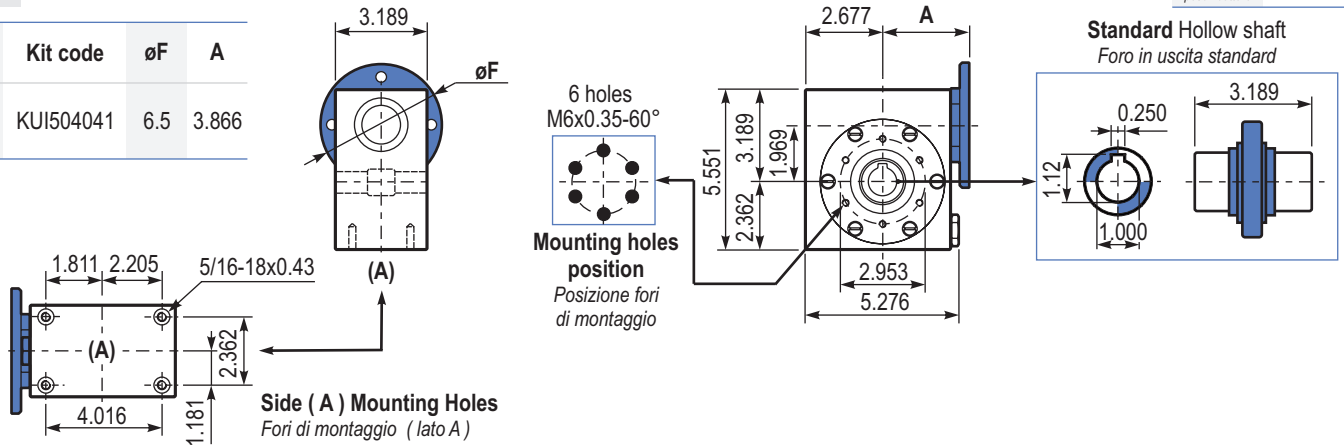

B150UNI... Modular base
Base modulare

PI50 **FLL...** Output flange
Flangia uscita

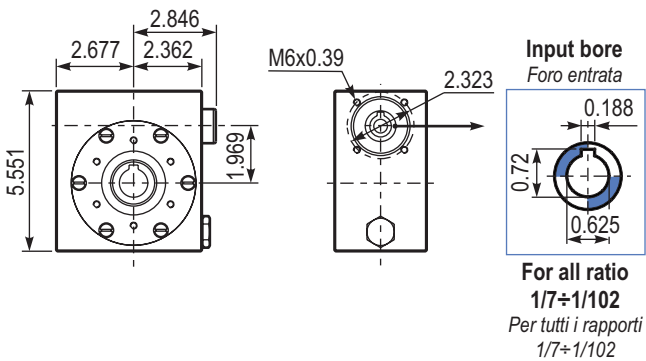

kit cod. KI509011

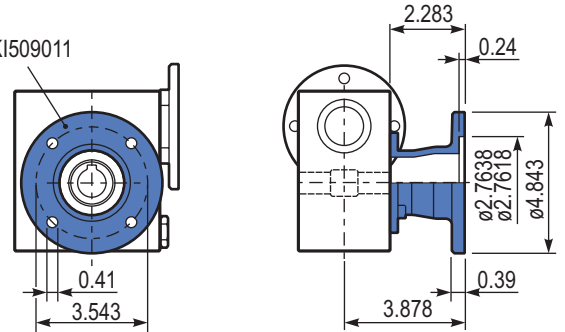

PI50 **BRI...** Reaction arm
Braccio di reazione

PI50.....**SID** Single Shaft
Albero lento semplice

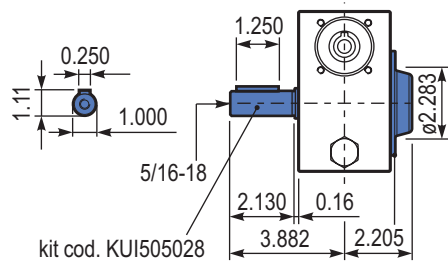
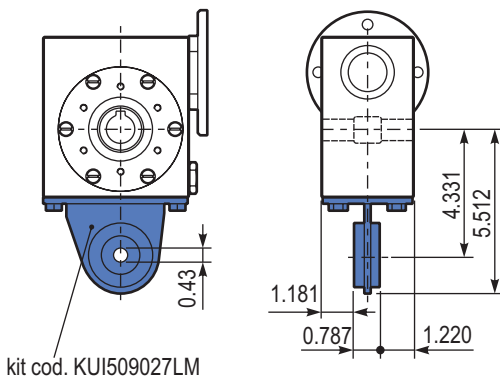

kit cod. KI500211
Protection cup (on request)
A richiesta coperchio di protezione