



The dynamic efficiency is **0.94** for all ratios

Input speed ( $n_1$ ) = 1750 min<sup>-1</sup>

Output speed $n_2$ [min <sup>-1</sup> ]	Ratio $i$	Motor power $P_{1M}$ [HP]	Output torque $M_{2M}$ [lb in]	Service factor $f.s$	Nominal power $P_{1R}$ [HP]	Nominal torque $M_{2R}$ [lb in]	Available NEMA motor flanges			Output shaft 	Ratio code 
							-W 56C	-			
34.8	50.35	0.75	1278	0.9	0.67	1151			171311		01
31.7	55.22	0.5	935	1.2	0.62	1151			17178		02
29.2	59.92	0.5	1014	1.1	0.57	1151			151311		03
26.6	65.72	0.5	1112	1.0	0.52	1151			15178		04
24.4	71.78	0.5	1215	0.9	0.47	1151			101711		05
22.0	79.44	0.5	1345	0.9	0.43	1151			13178		06
19.0	92.08	0.33	1029	1.1	0.37	1151			15138		07
18.4	95.03	0.33	1062	1.1	0.36	1151			91711	Standard ø1.000	08
13.8	126.55	0.33	1414	0.9	0.28	1204			71711		09
13.1	133.15	0.25	1127	1.1	0.27	1204			91311		10
11.7	150.18	0.25	1271	0.9	0.24	1204			61711		11
9.9	177.30	0.25	1501	0.8	0.20	1204			71311		12
8.3	210.42	0.25*	1781	0.7	0.17	1204			61311		13
7.6	230.79	0.25*	1953	0.6	0.15	1204			6178		14
6.4	272.47	0.25*	2306	0.5	0.13	1204			7138		15
5.4	323.37	0.25*	2737	0.4	0.11	1204			6138		16

\* Power higher than the maximum one which can be supported by the gearbox. Select according to the torque  $M_{2R}$

\* Potenza superiore a quella massima sopportabile dal riduttore. Selezionare in base al momento torcente  $M_{2R}$

-  **Motor flanges available**  
Flange motore disponibili
-  **B) Supplied with reduction bushing**  
Fornito con bussola di riduzione
-  **B) Available on request without reduction bushing**  
Disponibile a richiesta senza bussola di riduzione
-  **C) Motor flange holes position**  
Posizione fori flangia motore

## Lubrication

### Lubrificazione

Unit X43N is supplied with synthetic oil to assure long life lubrication.  
Food grade oil is available on request.



See Table 1 for lubrication and recommended quantity.

See Table 2 for possible radial and axial loads on the gearbox.

Il riduttore tipo X43N viene fornito con olio sintetico e lubrificazione tipo "long life".  
Disponibile a richiesta olio alimentare.

Vedi Tabella 1 per oli e quantità consigliati.

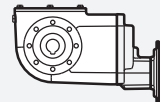
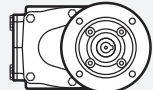
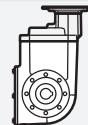
Vedi Tabella 2 per i carichi radiali e assiali applicabili al riduttore.

<b>Shell</b> Omala S4 WE 320	<b>Eni</b> Telium VSF 320	<b>V8</b> On request ASK	
<b>B3</b> Standard 31.68 oz		<b>B8</b> On request 29.92 oz	
<b>B6</b> On request 33.44 oz		<b>V5</b> On request 49.27 oz	
<b>B7</b> On request 26.40 oz		<b>V6</b> On request 31.68 oz	

For more details on lubrication and plugs check our website.  
Per maggiori dettagli su lubrificazione e tappi olio vedi il nostro sito web.

Tab. 1

## Radial and axial loads

### Carichi radiali e assiali

### Output shaft

#### Albero di uscita

$n_2$ [min <sup>-1</sup> ]	FA [lb]	FR [lb]
250	112	562
150	135	674
100	157	786
75	180	899
50	216	1079
25	216	1079
15	216	1079

$$F_{eq} = F_R \cdot \frac{4.75}{X + 3.69}$$

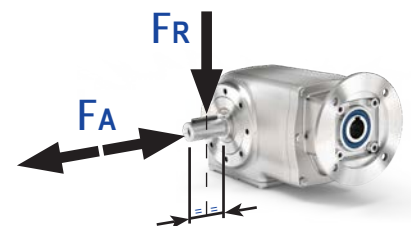
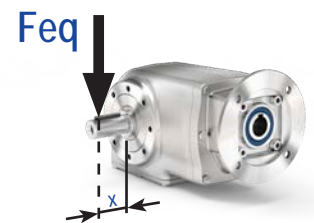

Tab. 2

**PX43NI...FB** Basic gearbox  
*Riduttore base*

M. flanges	Kit code	øF	A
56C	KUI504041	6.50	8.906
143/5 TC	KUI504041	6.50	8.906

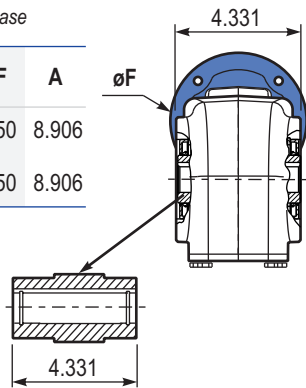

8 holes  
M8x0.67

**Mounting holes position**  
*Posizione fori di montaggio*

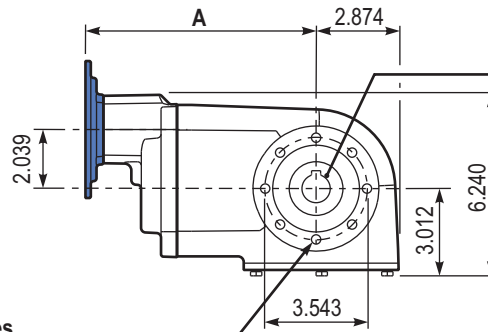

Gearbox weight  
*peso riduttore* **28.7 lb**

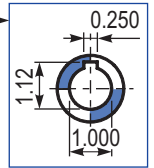

**Standard Hollow shaft**  
*Foro in uscita standard*

**PX43NPA..** Feet  
*Piedini*

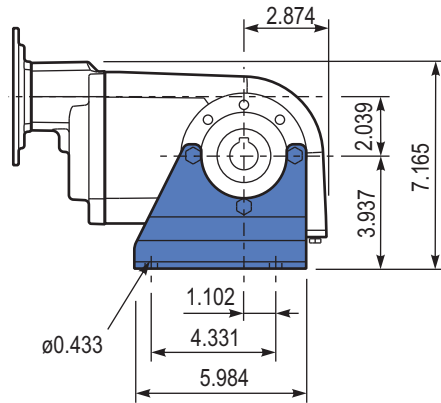
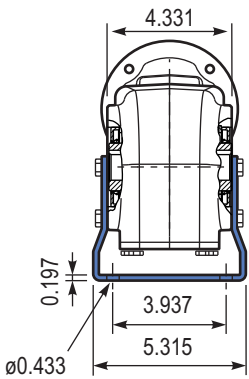

**PX43NPV..** Feet  
*Piedini*

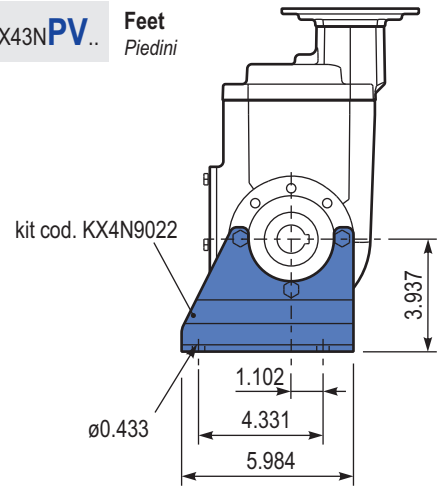

**PX43NFL..** Output flange  
*Flangia uscita*

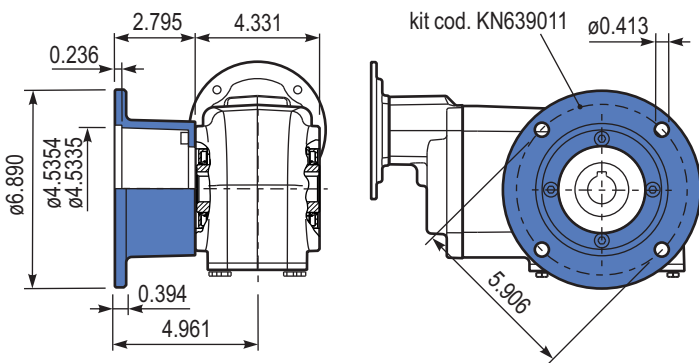

**PX43NBR..** Reaction Arm  
*Braccio di reazione*

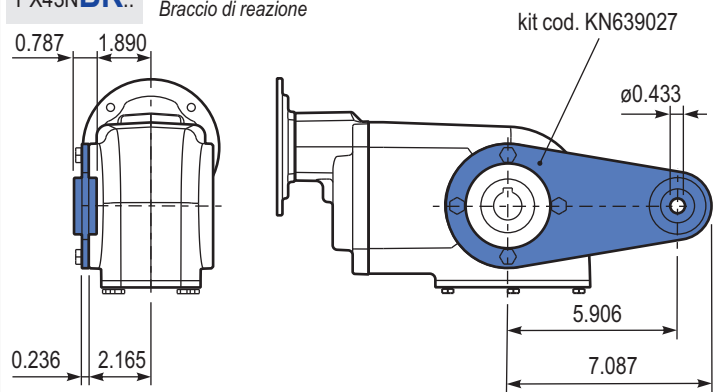

**PX43NA..** Single output shaft  
*Albero semplice in uscita*

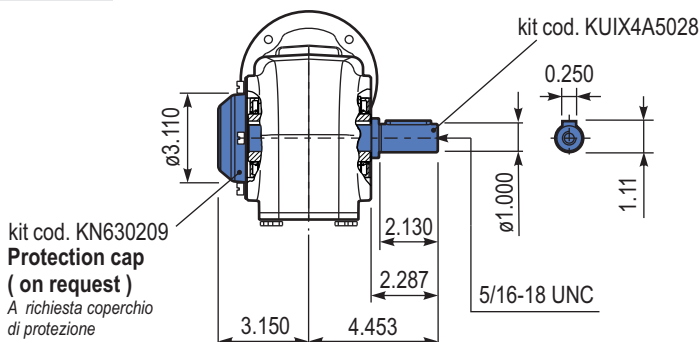

kit cod. KN630209  
**Protection cap**  
**(on request)**  
*A richiesta coperchio di protezione*

**Suggested**  
*Suggerito*

**Stainless steel protection cap**  
**(on request).**

*Coperchio di protezione in acciaio inox a richiesta.*

Kit cod. KN630209

