



The dynamic efficiency is **0.94** for all ratios

Input speed (n_1) = 1750 min⁻¹

Output speed n_2 [min ⁻¹]	Ratio i	Motor power P_{1M} [HP]	Output torque M_{2M} [lb in]	Service factor $f.s$	Nominal power P_{1R} [HP]	Nominal torque M_{2R} [lb in]	Available NEMA motor flanges				Output shaft 	Ratio code 
							-W 56C	-X 143-5TC	-Y 182/4TC			
220	7.94	5	1344	2.5	12.51	3363				302418	Standard ø1.500	01
192	9.13	5	1546	2.2	11.17	3452				302416		02
164	10.66	5	1804	2.0	10.06	3629				302414		03
117	14.97	5	2534	2.0	10.13	5133				202418		04
102	17.21	5	2913	1.8	9.12	5310				202416		05
86	20.24	5	3425	1.7	8.72	5974				162418		06
75	23.27	5	3938	1.5	7.58	5974				162416		07
67	26.31	5	4455	1.3	6.71	5974				132418		08
58	30.25	5	5122	1.2	5.83	5974				132416		09
49.5	35.32	5	5979	1.0	5.00	5974				132414		10
47.3	37.03	5	6269	1.0	4.76	5974				112416		11
40.5	43.23	3	4391	1.4	4.08	5974				112414		12
37.6	46.58	3	4731	1.3	3.79	5974				82418		13
32.7	53.55	3	5439	1.1	3.30	5974				82416		14
28.0	62.52	3	6350	0.9	2.82	5974				82414		15
23.7	73.75	2	4994	1.0	2.06	5133				62416		16
20.3	86.09	2	5830	1.0	2.05	5974				62414		17

* Power higher than the maximum one which can be supported by the gearbox. Select according to the torque M_{2R}

* Potenza superiore a quella massima sopportabile dal riduttore. Selezionare in base al momento torcente M_{2R}

Motor flanges available
Flange motore disponibili



B) Supplied with reduction bushing
Fornito con bussola di riduzione



B) Available on request without reduction bushing
Disponibile a richiesta senza bussola di riduzione



C) Motor flange holes position
Posizione fori flangia motore

Lubrication

Lubrificazione

Unit X73N is supplied with synthetic oil to assure long life lubrication. Food grade oil is available on request.

See Table 1 for lubrication and recommended quantity.

See Table 2 for possible radial and axial loads on the gearbox.

Il riduttore tipo X73N viene fornito con olio sintetico e lubrificazione tipo "long life".

Disponibile a richiesta olio alimentare.

Vedi Tabella 1 per oli e quantità consigliati.

Vedi Tabella 2 per i carichi radiali e assiali applicabili al riduttore.

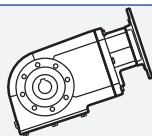
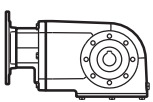
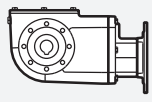
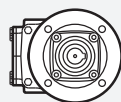
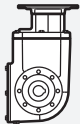
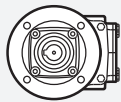
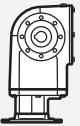
Shell Omala S4 WE 320	Eni Telium VSF 320	V8 On request ASK	
B3 Standard 56.31 oz		B8 On request 102.07 oz	
B6 On request 98.55 oz		V5 On request 161.90 oz	
B7 On request 73.91 oz		V6 On request 161.90 oz	

For more details on lubrication and plugs check our website.

Per maggiori dettagli su lubrificazione e tappi olio vedi il nostro sito web.

Radial and axial loads

Carichi radiali e assiali

Output shaft

Albero di uscita

n_2 [min ⁻¹]	FA [lb]	FR [lb]
300	306	1529
250	315	1574
200	324	1619
140	333	1664
120	342	1709
85	351	1754
70	387	1934
40	414	2068
15	432	2158

$$F_{eq} = F_R \cdot \frac{7.03}{X + 5.65}$$

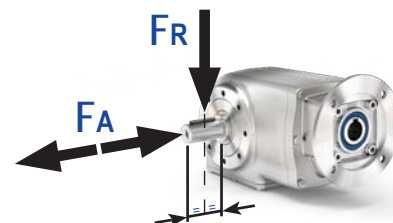
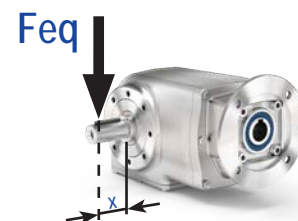

PX73NI...FB Basic gearbox
Riduttore base

M. flanges	Kit code	øF	A
56C-143/5TC	KUI854041	6.50	12.063
182/4TC	KUI854042	8.88	12.768

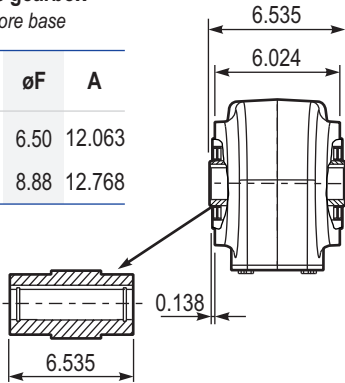

8 holes
M10x0.71

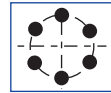

Mounting holes
position
Posizione fori di montaggio

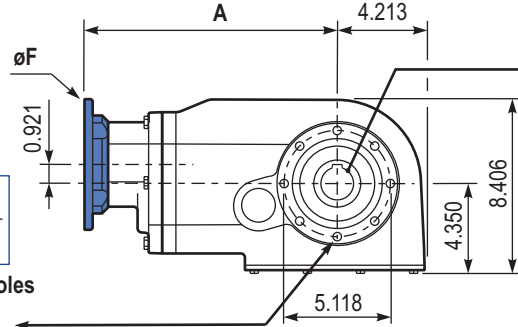

Gearbox weight
peso riduttore **68.3 lb**

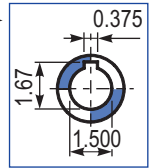

Standard Hollow shaft
Foro in uscita standard

PX73NPA.. Feet
Piedini

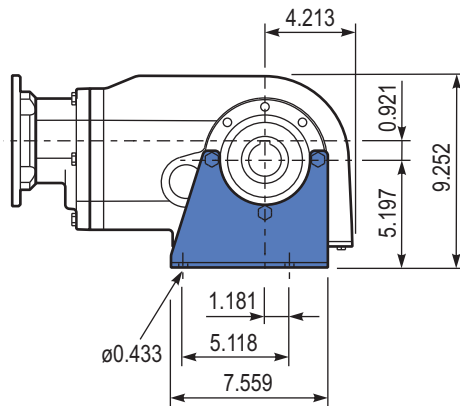
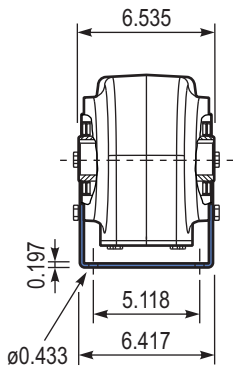

PX73NPV.. Feet
Piedini

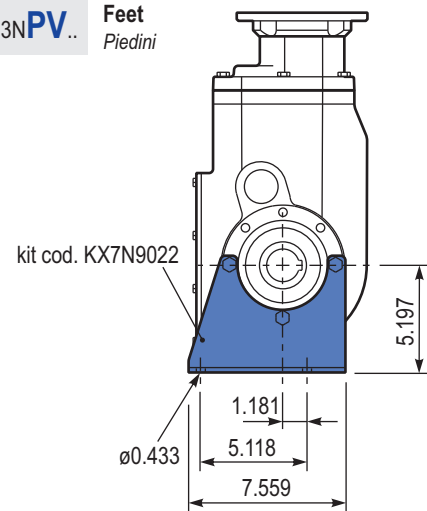

PX73NFL.. Output flange
Flangia uscita

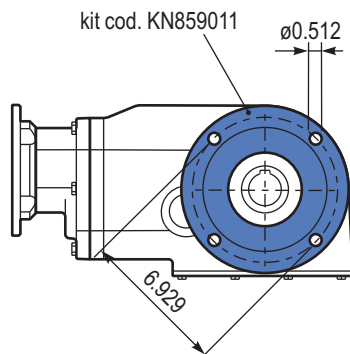
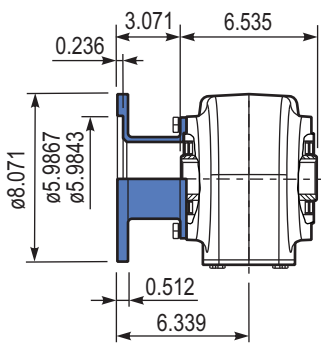

PX73NBR.. Reaction Arm
Braccio di reazione

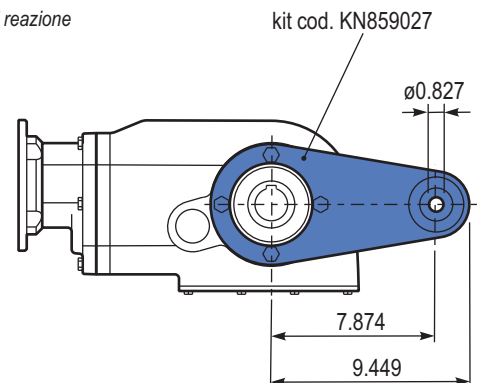
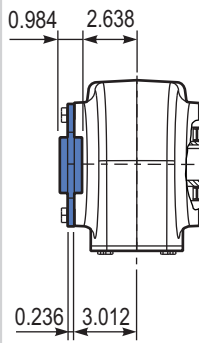

PX73NA.. Single output shaft
Albero semplice in uscita

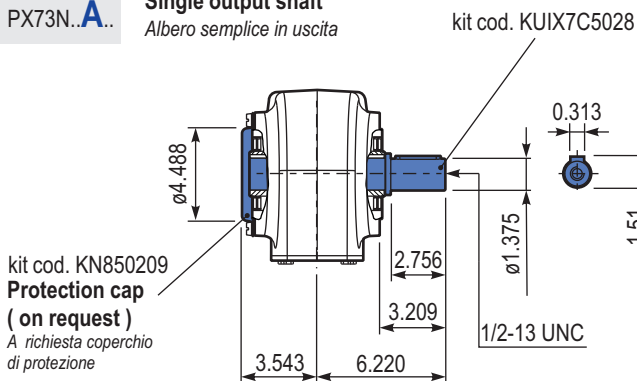

Suggested
Suggerito

Stainless steel protection cap
(on request).

Coperchio di protezione in acciaio inox a richiesta.

Kit cod. KN850209

