

The dynamic efficiency is **0.94** for all ratios

Input speed (n_1) = 1400 min⁻¹

Output speed n_2 [min ⁻¹]	Ratio i	Motor power P_{1M} [kW]	Output torque M_{2M} [Nm]	Service factor $f.s$	Nominal power P_{1R} [kW]	Nominal torque M_{2R} [Nm]	B5 motor flanges		B14 motor flanges		Output shaft 	Ratio code
							-	-	-P 63	-Q 71		
27.8	50.35	0.37	119	1.1	0.40	130			C		171311	01
25.4	55.22	0.37	131	1.0	0.37	130			C		17178	02
23.4	59.92	0.37	142	0.9	0.34	130			C		151311	03
21.3	65.72	0.25	105	1.2	0.31	130			C		15178	04
19.5	71.78	0.25	115	1.1	0.28	130			C		101711	05
17.6	79.44	0.25	127	1.0	0.26	130			C		13178	06
15.2	92.08	0.25	147	0.9	0.22	130			C		15138	07
14.7	95.03	0.25	152	0.9	0.21	130			C		91711	08
11.1	126.55	0.18	155	0.9	0.17	136			C	Standard ø25	71711	09
10.5	133.15	0.12	105	1.3	0.16	136			C		91311	10
9.3	150.18	0.12	119	1.1	0.14	136			C		61711	11
7.9	177.30	0.12	140	1.0	0.12	136			C		71311	12
6.7	210.42	0.12*	166	0.8	0.10	136			C		61311	13
6.1	230.79	0.12*	182	0.7	0.09	136			C		6178	14
5.1	272.47	0.12*	215	0.6	0.08	136			C		7138	15
4.3	323.37	0.12*	256	0.5	0.07	136			C		6138	16

* Power higher than the maximum one which can be supported by the gearbox. Select according to the torque M_{2R}

* Potenza superiore a quella massima sopportabile dal riduttore. Selezionare in base al momento torcente M_{2R}

-  **Motor flanges available**
Flange motore disponibili
-  **B) Supplied with reduction bushing**
Fornito con bussola di riduzione
-  **B) Available on request without reduction bushing**
Disponibile a richiesta senza bussola di riduzione
-  **C) Motor flange holes position**
Posizione fori flangia motore

Lubrication

Lubrificazione

Unit X43N is supplied with synthetic oil to assure long life lubrication. Food grade oil is available on request.

See Table 1 for lubrication and recommended quantity.

See Table 2 for possible radial and axial loads on the gearbox.

Il riduttore tipo X43N viene fornito con olio sintetico e lubrificazione tipo "long life". Disponibile a richiesta olio alimentare.

Vedi Tabella 1 per oli e quantità consigliati.

Vedi Tabella 2 per i carichi radiali e assiali applicabili al riduttore.

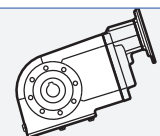
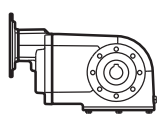
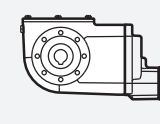
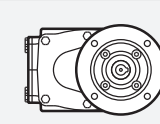
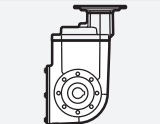
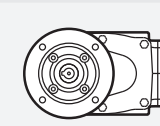
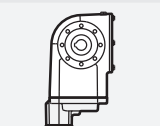
Shell Omala S4 WE 320	Eni Telium VSF 320	V8 On request ASK	
B3 Standard 0.90 L		B8 On request 0.85 L	
B6 On request 0.80 L		V5 On request 1.40 L	
B7 On request 0.75 L		V6 On request 0.90 L	

For more details on lubrication and plugs check our website.
Per maggiori dettagli su lubrificazione e tappi olio vedi il nostro sito web.

Tab. 1

Radial and axial loads

Carichi radiali e assiali

Output shaft

Albero di uscita

n_2 [min ⁻¹]	F_A [N]	F_R [N]
250	500	2500
150	600	3000
100	700	3500
75	800	4000
50	960	4800
25	960	4800
15	960	4800

$$F_{eq} = F_R \cdot \frac{123}{X + 97}$$

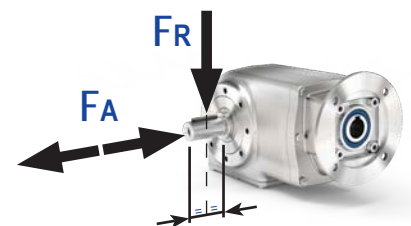
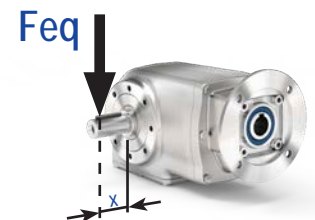

Tab. 2

PX43NI...FB Basic gearbox
Riduttore base

M. flanges	Kit code	øF	A
63B14	KI504047	90	206
71B14	KI504045	105	203.5

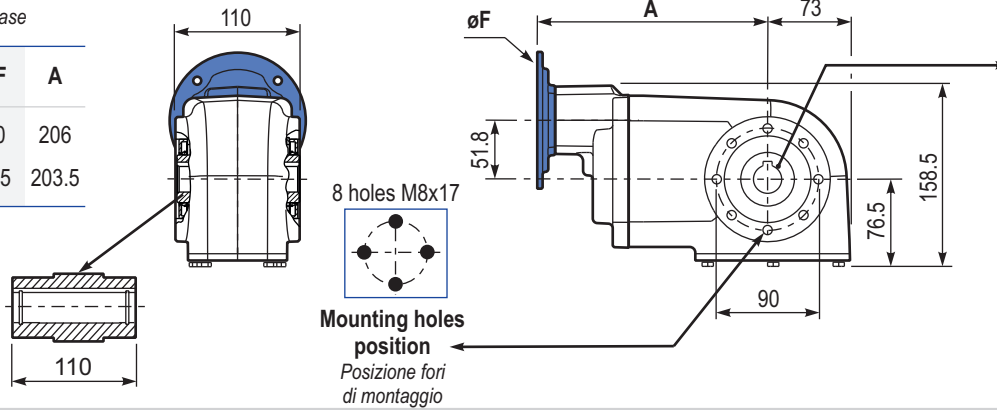

Gearbox weight
peso riduttore **13.0 kg**

Hollow shaft
Foro in uscita

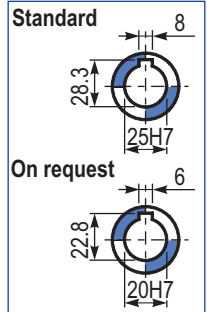

PX43NPA.. Feet
Piedini

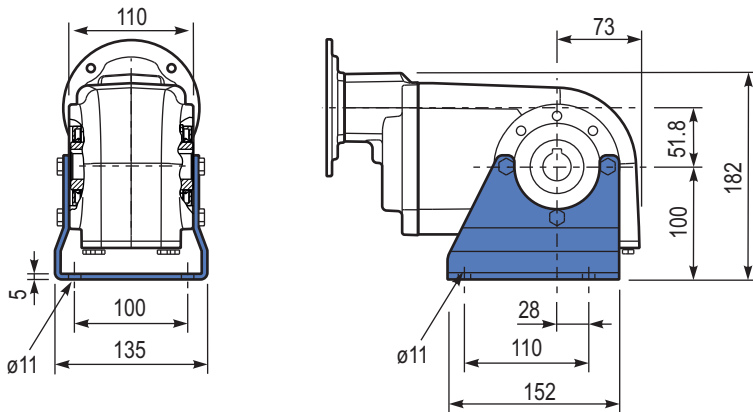

PX43NPV.. Feet
Piedini

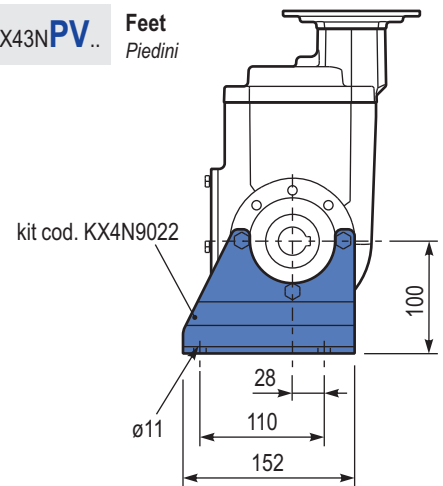

PX43NFL.. Output flange
Flangia uscita

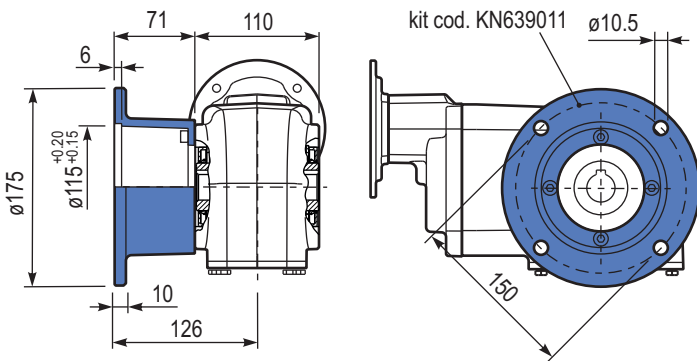

PX43NBR.. Reaction Arm
Braccio di reazione

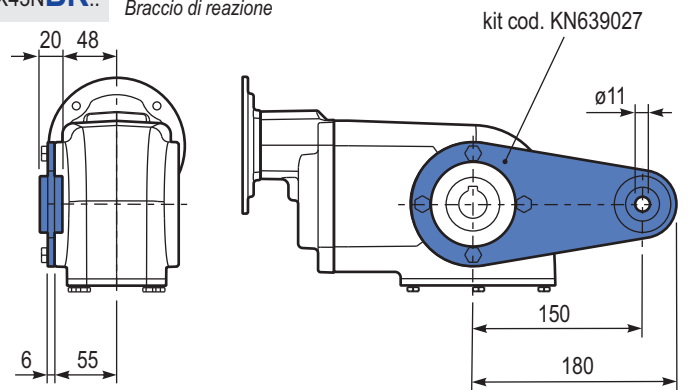

PX43NA.. Single output shaft
Albero semplice in uscita

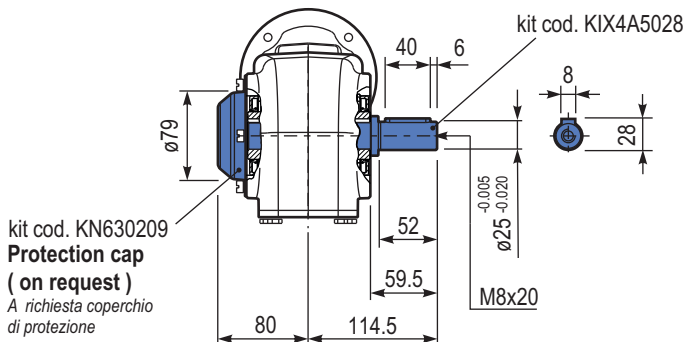

kit cod. KN630209
Protection cap
(on request)
A richiesta coperchio di protezione

Suggested
Suggerito

Stainless steel protection cap
(on request).

Coperchio di protezione in acciaio inox a richiesta.

Kit cod. KN630209

